

## READ BEFORE USE

English ..... 2

For questions: 1-800-851-8900.  
Visit [hamiltonbeach.com](http://hamiltonbeach.com) for our  
complete line of products and  
Use and Care Guides – as well  
as delicious recipes, tips, and to  
register your product online.

# Hamilton Beach®

Blend and Store  
System with  
FreshPress™ Lid



# IMPORTANT SAFEGUARDS

When using electrical appliances, basic safety precautions should always be followed to reduce the risk of fire, electric shock, and/or injury to persons, including the following:

1. Read all instructions.
2. This appliance is not intended for use by persons with reduced physical, sensory, or mental capabilities, or lack of experience and knowledge, unless they are closely supervised and instructed concerning use of the appliance by a person responsible for their safety.
3. This appliance shall not be used by children. Keep the appliance and its cord out of reach of children.
4. Close supervision is necessary when any appliance is used near children. Children should be supervised to ensure that they do not play with the appliance.
5. To protect against risk of electrical shock, do not put cord, plug, base, or motor in water or other liquid.
6. Turn the appliance **OFF (O)**, then unplug from outlet when not in use, before assembling or disassembling parts, and before cleaning. To unplug, grasp the plug and pull from the outlet. Never pull from the power cord.
7. Avoid contact with moving parts. Do not attempt to defeat any safety interlock mechanisms.
8. Do not operate any appliance with a damaged supply cord or plug, or after the appliance malfunctions or has been dropped or damaged in any manner. Supply cord replacement and repairs must be conducted by the manufacturer, its service agent, or similarly qualified persons in order to avoid a hazard. Contact Customer Service for information on examination, repair, or adjustment as set forth in the Limited Warranty.
9. The use of attachments, including canning jars, not recommended or sold by the appliance manufacturer may cause fire, electric shock, or personal injury.
10. Do not use outdoors.
11. Do not let cord hang over edge of table or counter or touch hot surfaces, including stove.
12. Do not place on or near a hot gas or electric burner, or in a heated oven.
13. Keep hands and utensils out of the jar and away from the cutting blade, while blending or chopping food, to reduce the risk of severe personal injury and/or damage to the blender or available attachments (attachments may not be provided with blender). A rubber spatula may be used but must be used only when blender is not running.
14. Blades are sharp; handle carefully—especially when assembling, disassembling, emptying or cleaning blender jar.
15. Do not use a broken, chipped, or cracked blender jar.
16. Do not use broken, cracked, or loose cutting blade.
17. Always operate blender with lid in place. Do not pull or push lid assembly unless fully assembled.
18. Do not use appliance for other than intended purpose.
19. Do not leave blender unattended while it is operating.
20. Check that the appliance is **OFF (O)** before plugging cord into wall outlet. To disconnect, turn the control to **OFF (O)**; then remove plug from wall outlet. To unplug, grasp the plug and pull from the outlet. Never pull from the power cord.
21. **CAUTION!** In order to avoid a hazard due to inadvertent resetting of the thermal cut-out, this appliance must not be supplied through an external switching device, such as a timer, or connected to a circuit that is regularly switched on and off by the utility.
22. If the jar should twist or rotate when the motor is switched **ON (I)**, switch **OFF (O)** immediately and tighten jar in collar or on blender base.
23. Ensure cutting blade is tight and secure to jar. Injury can result if moving blades accidentally become exposed.
24. Ensure personal jar blade holder is tight and secure. Injury can result if moving blades accidentally become exposed.

25. Risk of thermal burn injury due to excessive pressure in the travel jar. Do not blend hot liquids in the travel jar.

26. **WARNING!** Do not blend hot liquids.

27. Operating time cannot exceed 3 minutes for any accessory or speed setting.

## SAVE THESE INSTRUCTIONS

### Other Consumer Safety Information

**This appliance is intended for household use only. Use for food or liquids only.**

**⚠ WARNING Electrical Shock Hazard:** This appliance is provided with a polarized plug (one wide blade) to reduce the risk of electric shock. The plug fits only one way into a polarized outlet. Do not defeat the safety purpose of the plug by modifying the plug in any way or by using an adapter. If the plug does not fit fully into the outlet, reverse the plug. If it still does not fit, have an electrician replace the outlet.

The length of the cord used on this appliance was selected to reduce the hazards of becoming tangled in or tripping over a longer cord. If a longer cord is necessary, an approved extension cord may be used. The electrical rating of the extension cord

must be equal to or greater than the rating of the appliance. Care must be taken to arrange the extension cord so that it will not drape over the countertop or tabletop where it can be pulled on by children or accidentally tripped over.

If the blades lock and will not move, it will damage the motor. Do not use. Contact Customer Service for information.

Do not place blender jar or personal jar in the freezer filled with food or liquid. This can result in damage to the blades, personal jar blade holder, jar, blender, and possibly result in personal injury.

To avoid an electrical circuit overload, do not use another high-wattage appliance on the same circuit with this appliance.

### **Wattage/Peak Power Information**

The wattage/ampere rating of the blender is determined by an Underwriters Laboratory test and is based on available cutting blades, jar combinations, and attachments that may not be provided with your unit, but are available as replacement parts. This is a measure of input wattage/amperes after 30 seconds of operation.

**NOTE:** This machine is equipped with motor overload protection. If the motor stops during operation due to overheating, unplug and allow it to cool down for approximately 15 minutes. Plug machine back in to resume normal operation.

Peak power is the measure of the motor wattage during the first seconds of operation. This is when a blender requires the most power to crush ice, frozen fruit, etc. This is a better measure of what a blender motor can consume when power is needed most.

# Parts and Features

To order parts, visit:  
[hamiltonbeach.com/parts](http://hamiltonbeach.com/parts)

1	Lid Assembly
1a	Lid Handle
1b	Lid
1c	Lid Seal
2	Blender Jar
3	PULSE Button
4	Base
5	Control Panel
6	Indicator Lines (on Lid)
7	Personal Jar Blade Holder
8	⏻ (Standby) Button
9	Drinking Lid
10	Personal Jar
11	AutoBlend™ Buttons
12	Manual Buttons
13	Blades
14	Power I/O (ON/OFF) Switch

**Before first use:** Wash everything except Blender Base in hot, soapy water. Dry thoroughly. Wipe Blender Base with a damp cloth or sponge. **DO NOT IMMERSE BASE IN WATER.** Care should be taken when handling Blades as they are very sharp.

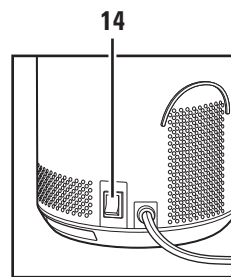
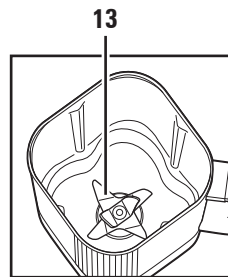
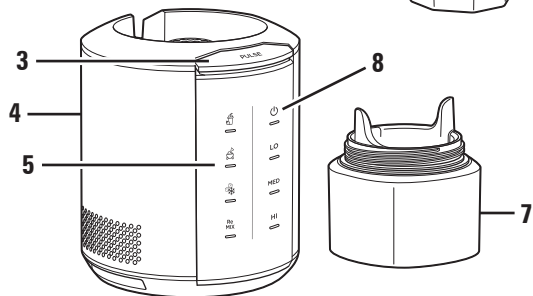
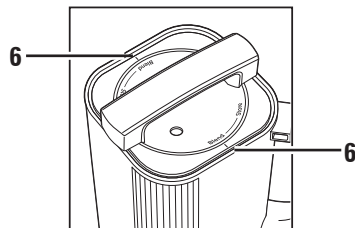
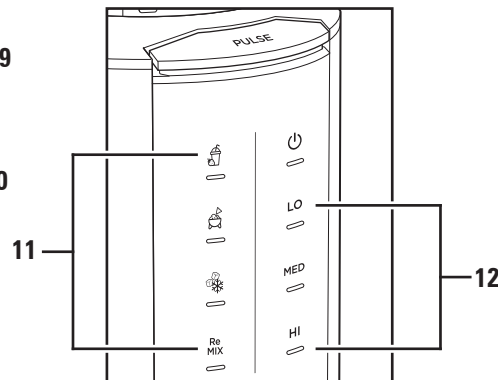
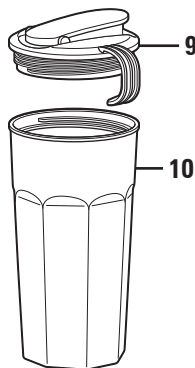
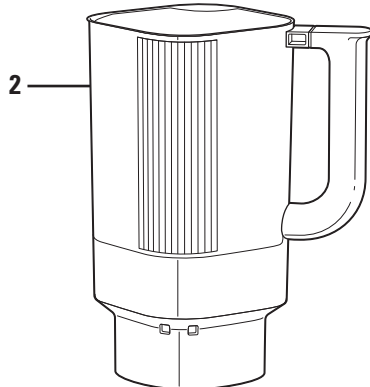
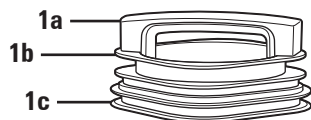

Hamilton Beach in no way guarantees the availability of replacement parts, repair services and information necessary to repair our products. For information on what parts and repair services may currently be available, please contact us using the methods provided in this manual.



# Control Panel

## Program Settings

Programs are optimized for recipe categories and vary in blending speed and duration. Touching a Program Button illuminates only the program selected. The Blender automatically starts when the Program Button is touched and automatically stops at the end of the program. To stop Blender before program cycle ends, touch the Program Button again or touch ⏻ (Standby) Button. Pressing the Program Button again will reset the program, and it will start back from the beginning.

	<b>Smoothie Program:</b> Blend smoothies, icy drinks, protein shakes, and milkshakes.
	<b>Dip Program:</b> Make hummus, salsa, guacamole, dressing, and more. Some recipes may be well blended before Program ends. You may press Standby button at any time to stop blending.
	<b>Ice Crush Program:</b> Break ice into small pieces for slushies and cocktails. <b>NOTE:</b> Do not allow ice to stand or freeze in Jar. Immediately crush ice after placing in Jar. For best results, crush ice in batches (about 14 cubes at a time).
<b>Re MIX</b>	<b>ReMIX Program:</b> Refresh your smoothie or drink for improved texture after storing in refrigerator.

## Manual Settings

LO, MED and HI manual settings give full control over speed, duration and blending technique, allowing the ability to tailor the blending process to the specific texture or consistency desired. Blender will automatically adjust power based on the ingredients in Jar to maintain selected speed.

## PULSE Button

Use for quick bursts of high speed blending during manual operation to add a boost of power momentarily, or to incrementally blend recipes that require a chunkier texture. It allows precise control of the duration and frequency of blending ingredients such as sweet and savory crumb toppings, meat salad for sandwich fillings or chopped fruits and vegetables. **NOTE:** Pulse will stop after 30 seconds if continually pressed.

# How to use Lid Assembly

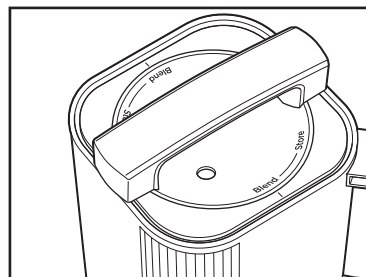

**Blend Position**

1. Place ingredients to be blended inside Jar.
2. Push Lid onto Jar until Handle rests on top edge.
3. Make sure Handle is turned to "Blend" position.

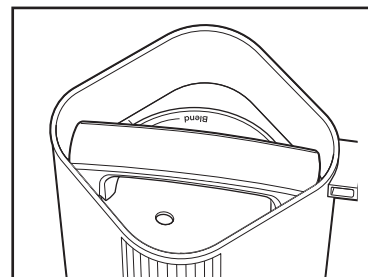

**Store Position**

1. To store your drink for later, grasp Handle and turn clockwise until "Store" aligns with Indicator Lines on Lid.
2. Press Lid down inside Jar until it almost touches top of mixture. You will hear air being pushed out of Jar.
3. Store in refrigerator for up to 3 days.

## For best results when storing in refrigerator:

1. Chill smoothie or drink immediately after blending
2. Separation during storage is normal. Use ReMIX Program to improve taste and texture before consuming.
3. A small amount of lemon or lime juice may be added to help preserve color and flavor.
4. Smoothies made with nondairy liquid such as plant-based milk typically stay fresh longer.
5. For a frosty texture, add a few ice cubes and blend on HI for 15–30 seconds to refresh.

# Using Your Blender

**Important:** Your Blender Jar and Blades are subject to wear during normal use. Always inspect Jar for nicks, chips, or cracks. Always inspect Blades for broken, cracked, or loose blades. If Jar or Blades are damaged, do not use. Visit [hamiltonbeach.com/parts](http://hamiltonbeach.com/parts) to obtain replacement parts.

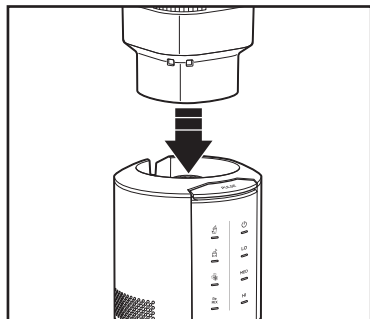

1. Place Blender Jar on Base. Push Jar down firmly to engage with Base.
2. Add ingredients to Jar. Add liquid ingredients first (at least 8 oz. [238 mL]), then other ingredients. DO NOT fill ingredients above 52 oz. (1500 mL) fill line. DO NOT blend hot ingredients.

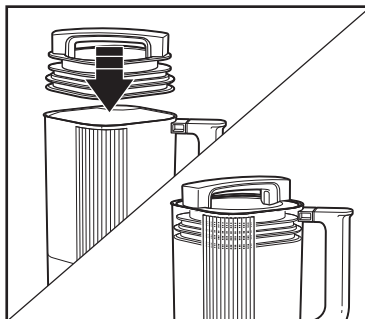
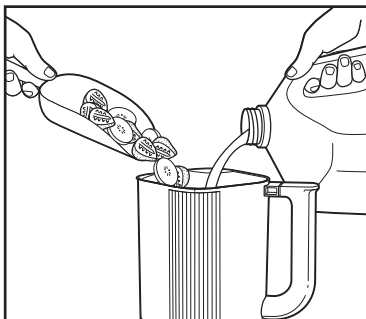

3. Push Lid onto Jar until Handle rests on top edge.

**▲ WARNING Burn Hazard.** Do not blend hot ingredients in blender. Pressure may build, causing lid to pop off and hot ingredients to erupt.

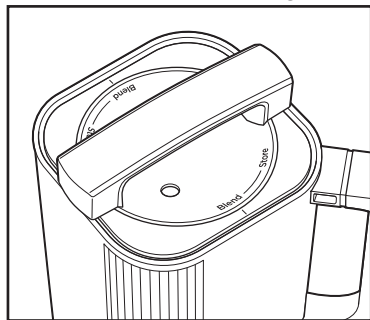

4. Make sure Handle is turned to "Blend" position before turning on Blender.

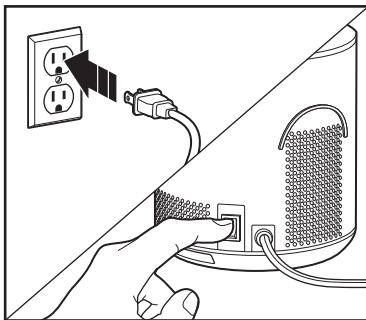

5. Plug into outlet. Press Power I/O (ON/OFF) Switch to ON (I) position. Switch will be red when in ON (I) position. ⏻ (Standby) Button will illuminate.

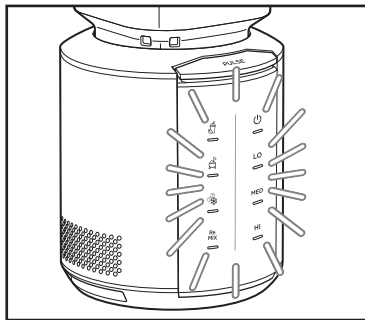

6. Touch ⏻ (Standby) Button. Control Panel buttons illuminate. **NOTE:** Control Panel goes to ⏻ (Standby) after 30 seconds and goes to sleep after 5 minutes for energy efficiency.

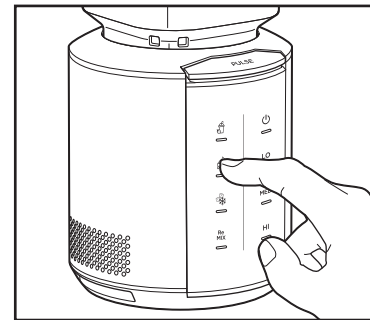

7. For programmed settings: Touch preferred Program Button to start blending. Touch Program Button again or ⏻ (Standby) Button to stop blending.

# Using Your Blender (cont.)

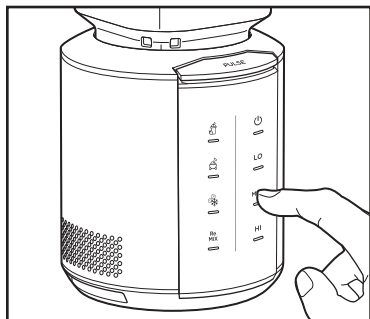

8. For manual settings: Touch HI, MED, OR LO buttons. To switch between manual settings, touch desired button. To stop blending, touch button again or touch (⏻) (Standby) Button.
9. Wait until Blades completely stop before removing Jar. Unplug. Remove Blender Jar from Base.

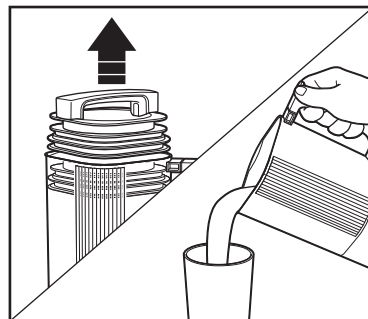
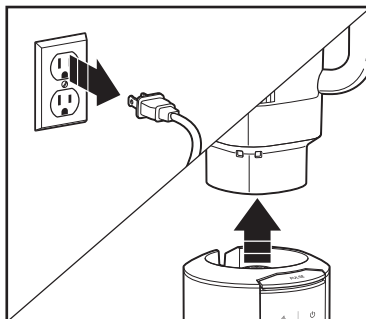

10. Grasp Handle and lift Lid until it reaches top of Jar. Allow Handle to return to Blend position before removing Lid from Jar. Pour mixture into container or Personal Jar and attach Drinking Lid.

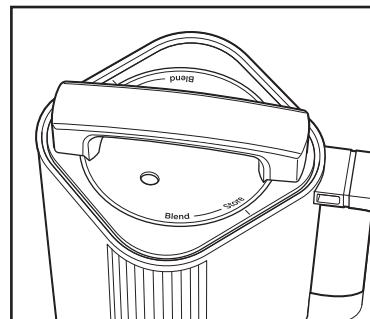

11. To store your blended mixture for later, turn Handle clockwise to align "Store" with Indicator Lines on Lid.

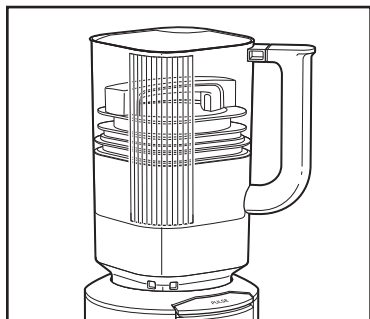

12. Press Lid down until it almost touches top of mixture in Jar.

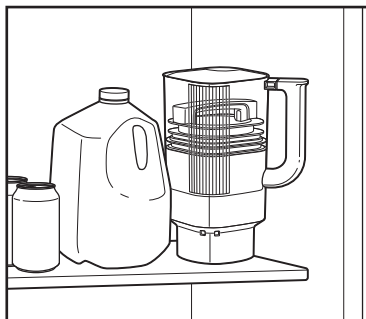

13. Store Jar in refrigerator. DO NOT store in freezer.
14. To refresh stored mixture, place Jar on counter, then grasp Handle and pull straight up until Lid is at top of Jar. Turn Handle to "Blend" position before blending. DO NOT BLEND WITH LID PUSHED INSIDE JAR IN "Store" POSITION.

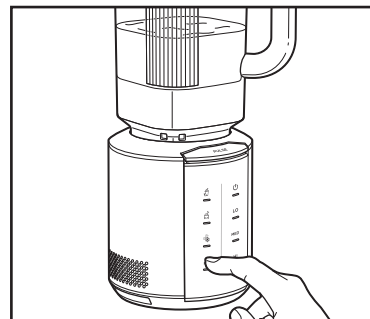
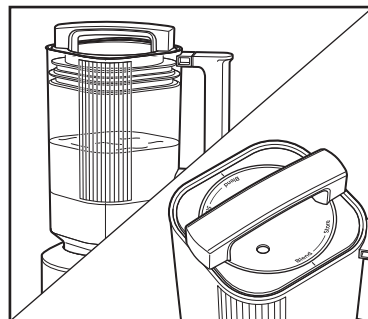

15. Touch ReMIX Button to blend mixture. If desired, add other ingredients to mixture, using a program or manual setting.

# Blending Tips

- For best performance, minimum amount of liquid needed per recipe is one cup (8 oz./237 mL). Always place liquid in Blender Jar first, then remaining ingredients. Add more liquid if food is not blending properly.
- If blending action stops during blending or ingredients stick to sides of Jar, there may not be enough liquid in Jar to blend efficiently.
- Cutting large whole fruits and vegetables may allow them to blend more quickly.
- If ice or frozen fruit pieces are not blending, stop the Blender and pulse a few times.
- Do not allow ice to stand or freeze in Jar. Immediately crush ice after placing in Jar.
- Do not try to mash potatoes, mix stiff dough, whip egg whites, grind raw meat, or extract juices from fruits and vegetables.
- Do not fill Blender Jar above the MAX fill line.
- Avoid bumping or dropping Blender when in operation or at any time.



# Using Personal Jar

## **⚠ WARNING Burn Hazard.**

Do not blend hot ingredients in travel jar. Pressure may build, causing jar to pop off and hot ingredients to erupt.

**⚠ WARNING Laceration Hazard.** Handle blades carefully; they are very sharp.

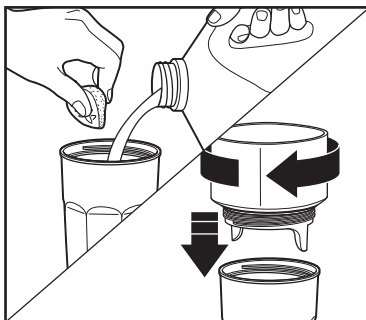

1. Make sure unit is unplugged. Add ingredients to Personal Jar in order listed on graphic on side of Jar. DO NOT fill ingredients above MAX fill line. Carefully place Personal Jar Blade Holder onto Personal Jar.

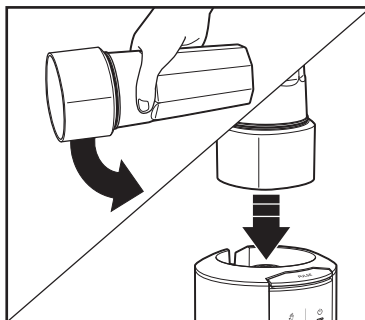

2. Turn Personal Jar upside down, shake to mix ingredients, and place onto Blender Base.

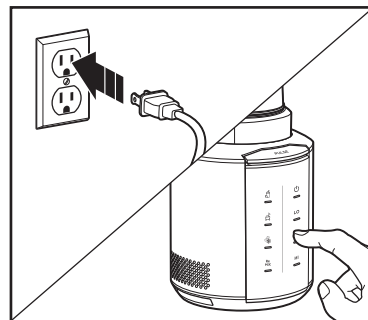

3. Plug into outlet. Touch desired program or manual setting to blend. Touch selected program button again, selected manual setting button again, or (Standby) Button to stop blending. Always operate on a countertop or other supporting surface.

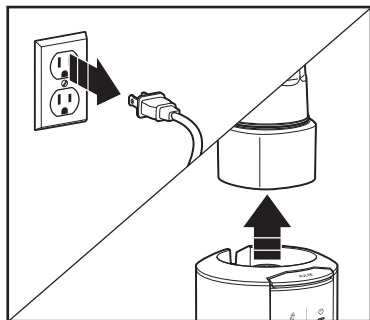

4. Wait until Blades completely stop before removing Jar. Unplug. Remove Jar from Base.

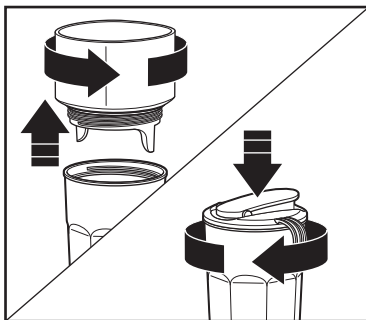

5. Turn bottom up; remove Personal Jar Blade Holder from Jar. Hand-tighten Drinking Lid onto Personal Jar.

## Blending Tips for Personal Jar

- When filling Personal Jar, add ingredients in this order: 1. Liquids 2. Ice/frozen fruit 3. Leafy greens 4. Seeds, powders, nut butters or other boosts 5. Yogurt/fresh fruit.
- For best performance in Personal Jar, minimum amount of liquid needed per recipe is 3/4 cup (6 ounces/177 mL).
- If blending action does not start, stops during blending, or ingredients stick to sides of Jar, stop blending. Remove Jar, shake contents, and return to blending.
- Do not chop or process hard foods such as cheese, crackers, or meat.
- Avoid bumping or dropping Blender.
- DO NOT blend hot liquids in Personal Jar.
- DO NOT fill Personal Jar above MAX fill line.

# Care and Cleaning

1. UNPLUG.
2. For Blender Jar: HAND WASH ONLY. Remove Blender Jar from Base. Wash in hot, soapy water. Rinse with clean water and dry thoroughly before storing.
3. Lid Assembly, Personal Jar, Personal Jar Blade Holder, and Drinking Lid are dishwasher-safe. DO NOT use "SANITIZE" setting when washing in dishwasher. SANITIZE cycle temperatures could damage your product. These parts may also be washed in hot, soapy water and rinsed with clean water. Dry thoroughly before storing.
4. ENSURE BASE IS UNPLUGGED. Wipe Blender Base and power cord with a damp cloth or sponge. To remove stubborn spots, use a mild, nonabrasive cleaner.

## To Quickly Clean Blender Jars

- Use this method to rinse Blender Jars between batches of processing same food.
- This method is NOT a substitute for regular cleaning as instructed in Care and Cleaning above.
- To avoid cross-contamination, this method should never be used when blending any mixture containing eggs, milk, or any other dairy products, meats, or seafood.

**FOR BLENDER JAR:** Pour 2 cups (473 mL) warm water in Jar and add 1 drop liquid dishwashing detergent. Run Blender on HI for 30-40 seconds. Discard soapy water. Rinse with clean water. Dry thoroughly before storage.

**FOR PERSONAL JAR:** Pour 1 cup (237 mL) warm water in Jar and add 1 drop liquid dishwashing detergent. Run Blender on HI for 15-20 seconds. Discard soapy water. Rinse with clean water.

## **⚠ WARNING** Electrical Shock Hazard.

Disconnect power before cleaning. Do not immerse cord, plug, base, or motor in water or other liquid.

## **Disassembling and Reassembling Lid**

Lid Assembly comes apart for thorough cleaning.

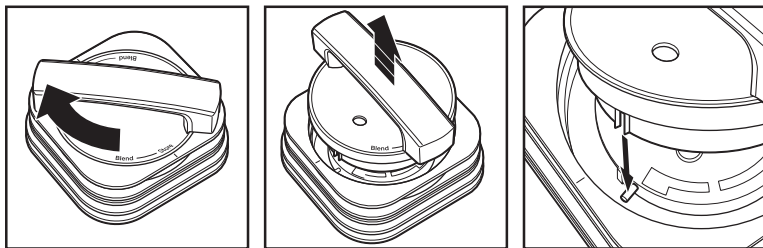

1. **To disassemble:** Grasp Lid Assembly and turn Handle clockwise past 'Store' until Handle stops.
2. Lift Handle straight up to separate from bottom portion of Lid Assembly. Follow Care and Cleaning step 4 to clean.
3. **To reassemble:** Align groove in Lid with metal pin inside bottom portion of Lid Assembly. Gently push down while turning Handle clockwise until Lid falls into place. When Handle is released it will rotate to "Blend" position due to spring force.

# Troubleshooting

## **Blender fails to start.**

- Power I/O (ON/OFF) Switch is turned O (OFF). Press Power Switch to I (ON) position before blending.
- Check to see if unit is securely plugged into an electrical outlet of proper voltage and frequency.
- Check to see if fuse for electrical outlet has blown or if a circuit breaker has tripped.
- Blender stops blending.
- This blender is equipped with thermal overload protection to extend the life of the Blender. If it gets too warm, it will automatically stop in order to prevent damage to the motor. Simply unplug the unit and allow it to cool for about 15 minutes. Once cooled, plug it back in and you're ready to blend again.

## **Ingredients will not mix properly.**

- Check to see if enough liquid has been added. Add liquid ingredients first (at least 8 oz. (238 mL), then other ingredients to Jar.
- Blender Jar is too full. DO NOT fill ingredients above 52 oz. (1500 mL) fill line.
- If ingredients still won't mix, try adding more liquid.
- Solid pieces are too large. Cut large pieces of fruit or vegetables into smaller, similar sized pieces.
- Try a different speed or program.
- Blades are not sharp or are damaged. Inspect Blender Jar and Blades before each use.

## **Blender smells like it is burning.**

- Press ⏻ (Standby) Button and then press Power I/O (ON/OFF) Switch to O (OFF) and allow unit to cool.
- Although motors are tested during manufacturing process, heavy use may cause curing of motor windings. This smell may quickly dissipate after a few heavy uses.
- If smell continues after additional heavy uses, visit [hamiltonbeach.com](http://hamiltonbeach.com) or call our Customer Care Center at 1.800.851.8900 in the U.S. or 1.800.267.2826 in Canada.

## **Blades don't spin.**

- Jar is not fully seated on the base. Press Jar down firmly to engage with Base.
- Mixture in Blender is too heavy a load for the motor. This blender is programmed to stop running to protect itself from electrical damage. Remove some of the ingredients from the Blender Jar. Try using a higher speed.

## **Large Blender Jar is cloudy or stained (not Personal Jar).**

- Some cloudiness may be natural after use. The minerals from fruits, produce, and leafy greens, in addition to the oils of various recipes, can sometimes cause a film on the Blender Jar or may be difficult to clean.
- Sprinkle 1/4 cup (59 mL) baking soda in Blender. Add 1 cup (237 mL) white vinegar. Mixture will bubble. When bubbling subsides, add 2 cups (473 mL) water and blend on HI. Wash any remaining residue with dish soap and water. Rinse and dry thoroughly.

## **Control Panel is completely dark.**

- Ensure product is plugged in.
- Ensure Power I/O (ON/OFF) Switch is switched to I (ON)
- Touch ⏻ (Standby) Button to illuminate all speeds and functions.

# Limited Warranty

This warranty applies to products purchased and used in the U.S. and Canada. This is the only express warranty for this product and is in lieu of any other warranty or condition.

This product is warranted to be free from defects in material and workmanship for a period of three (3) years from the date of original delivery in the U.S. and Canada. During this period, your exclusive remedy is replacement of this product or any component found to be defective, at our option; however, you are responsible for all costs associated with our returning a product or component under this warranty to you. If the product or component is unavailable, we will replace with a similar one of equal or greater value.

This warranty does not cover glass, filters, wear from normal use, use not in conformity with the printed directions, or damage to the product resulting from accident, alteration, abuse, or misuse. This warranty extends only to the original consumer purchaser or gift recipient. Keep the original sales receipt, as proof of purchase is required to make a warranty claim. This warranty is void if the product is used for other than single-family household use or subjected to any voltage and waveform other than as specified on the rating label (e.g., 120 V ~ 60 Hz).

We exclude all claims for special, incidental, and consequential damages caused by breach of express or implied warranty. All liability is limited to the amount of the purchase price. **Every implied warranty, including any statutory warranty or condition of merchantability or fitness for a particular purpose, is disclaimed except to the extent prohibited by law, in which case such warranty or condition is limited to the duration of this written warranty.** This warranty gives you specific legal rights. You may have other legal rights that vary depending on where you live. Some states or provinces do not allow limitations on implied warranties or special, incidental, or consequential damages, so the foregoing limitations may not apply to you.

To make warranty claim, do not return this appliance to the store. Please call 1.800.851.8900 in the U.S. or 1.800.267.2826 in Canada or write Hamilton Beach Brands, Inc., Attn: Consumer Affairs, 261 Yadkin Road, Southern Pines, NC 28387, or visit [hamiltonbeach.com/customer-service](http://hamiltonbeach.com/customer-service) in the U.S. or [hamiltonbeach.ca/customer-service](http://hamiltonbeach.ca/customer-service) in Canada. For faster service, include the model, type, and series numbers on your appliance.